

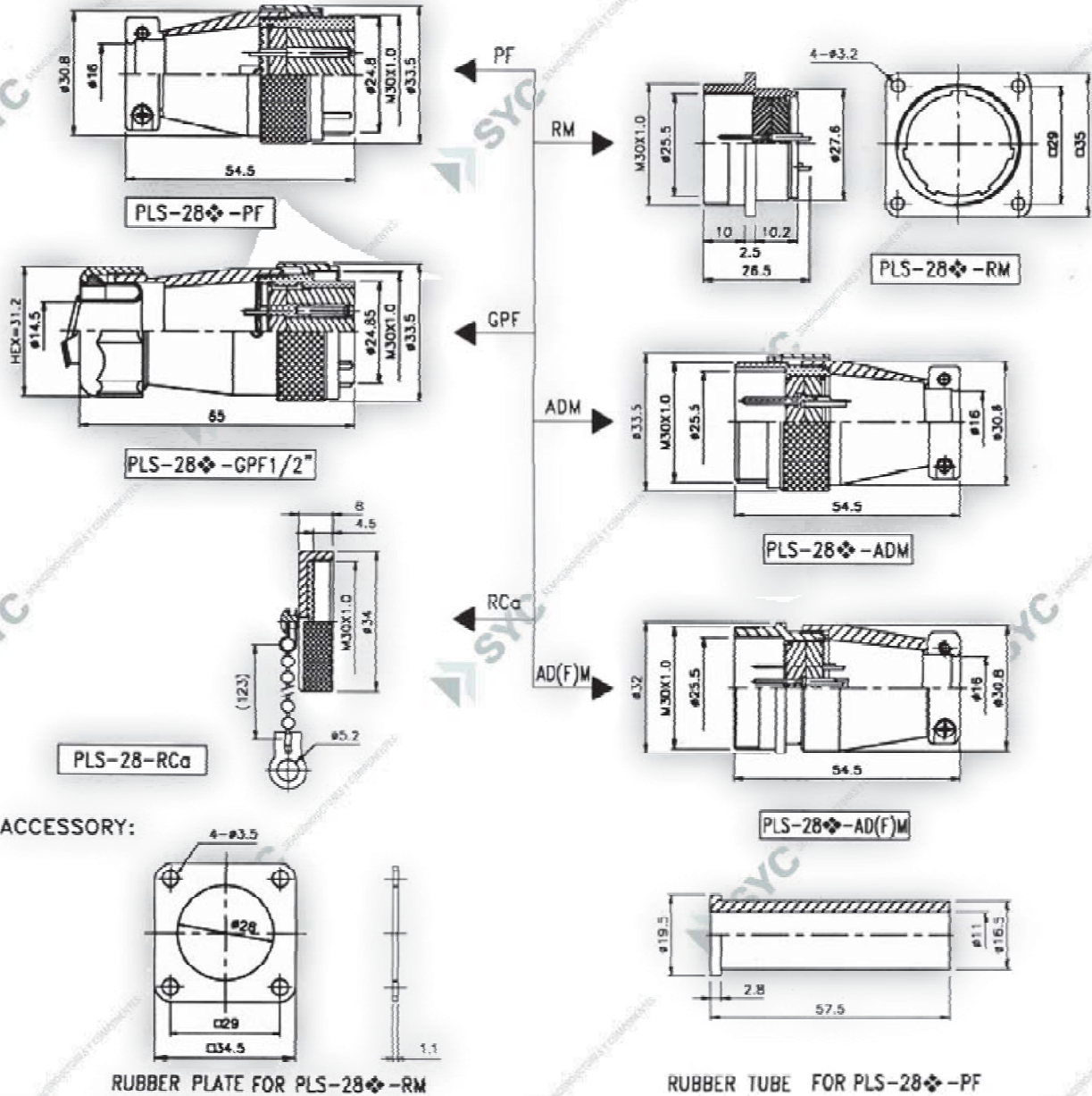





CODIGO

PLS-2826-XX

DESCRIPCION

Conector tipo industrial serie PLS de 26 vias

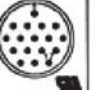

◆ No. of contacts	7	12	16	17	20	26			
Contacts Configuration									
Rated current/voltage	15A 250V	10A 250V	5A 250V	5A 250V	5A 250V	5A 250V			
Operation limit voltage (AC.V.rms)	300	250	250	250	250	250			
Withstanding voltage (AC.V.rms) 1 minute	1800	1000	1000	1000	1000	1000			
Insulation resistance (MΩ MIN.) at DC 500V	1800	1000	1000	1000	1000	1000			
Contact resistance (mΩ MAX.) at DC 1A	3	5	5	5	3	3			
Pin diameter (ømm)	2	1.6	1.6	1.6	1.2	1.2			

CODIGO

PLS-2826-XX

DESCRIPCION

Conector tipo industrial serie PLS de 26 vias

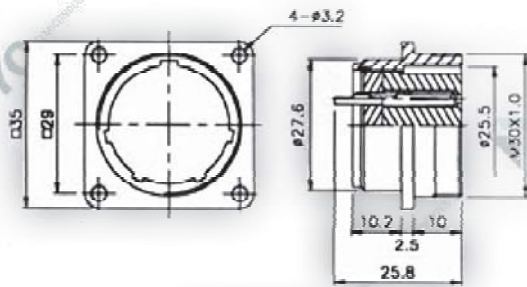

PLS-28-RF

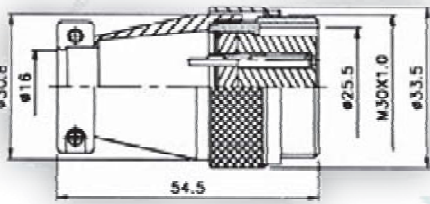

PLS-28-ADF

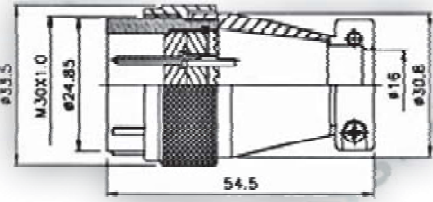

PLS-28-PM

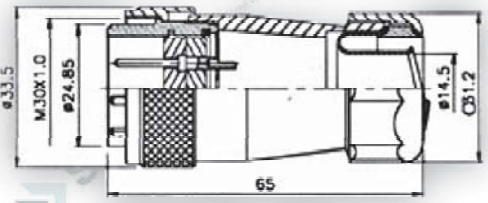

PLS-28-GPM1/2

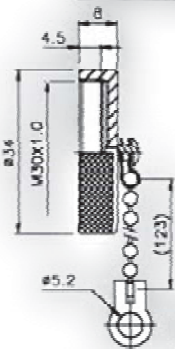

PLS-28-RCO

ACCESSORY:

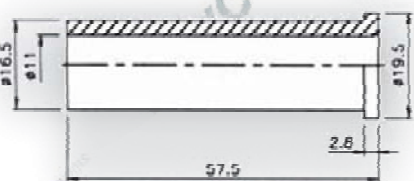

RUBBER TUBE FOR PLS-28-PM

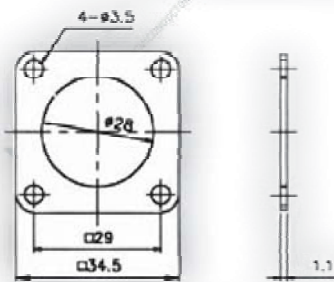

RUBBER PLATE FOR PLS-28-RF

◆ No. of contacts	7	12	16	17	20	26			
Contacts Configuration									
Rated current/voltage	15A 250V	10A 250V	5A 250V	5A 250V	5A 250V	5A 250V			
Operation limit voltage (AC.V.rms)	300	250	250	250	250	250			
Withstanding voltage (AC.V.rms) 1 minute	1800	1000	1000	1000	1000	1000			
Insulation resistance (MR MIN.) at DC 500V	1800	1000	1000	1000	1000	1000			
Contact resistance (mΩ MAX.) at DC 1A	3	5	5	5	3	3			
Pin diameter (#mm)	2	1.6	1.6	1.6	1.2	1.2			